



Thank you for buying the bench Zaandam.

In this manual we explain step by step how to assemble the bench.

This manual is for the following sizes:

150/180/200cm.



2 x 150,180 of 200 cm



2 x 150,180 of 200 cm x 3 cm



4 x 40 cm



5 x 29 x 3 cm



4 x 40 x 3 cm



+ 2x screws 30mm and screws 50mm

### What tools do you need?

-Screw machine

-Pen

-Sandpaper (we advise P100)

-Saw

-Drill (size 4)

-Tape measure

-Saw

### Step 1: Sandpaper

Sandpaper the edges from the planks, make sure there aren't any bumps

### Step 2: The side panels

You need the following planks/slats:

-2 x 40cm

-2 x 40x3 cm

-2 x 29x3 cm



Laydown the planks from 40cm according the picture. It is important that the bulging of the plank is on the downside. (like the picture).

The slats 40x3cm have to be equal to the planks. The slats (29cm) you mount in between. The slats can be longer so it is possible you have to shorten them.

Repeat this process twice so you create 2 side panels.

### Step 3: The side panels.

Drill 14 holes like the example in the picture. When done mount the beam to the planks with the screw machine. Do this on both sides. Be careful not to mount the slats to close to each other, the shackle has to be mounted in between for support.

Use the 50mm screws.

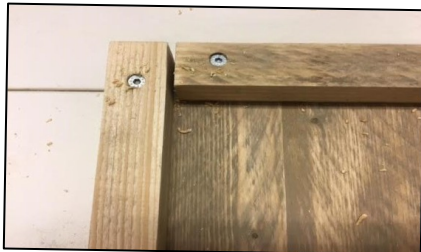

### Step 4: The seat

You'll need the following planks and slats:

-2 x150,180 or 200 cm planks

Laydown 2 planks (150,180, or 200cm) next to each other. Drill 4 holes in the side panels and mount them with the 50mm screws. Make sure that the screws aren't too far in.



Step 5:

You'll need the following planks and slats:

-2 x 150,180 of 200 x 3 cm slats

The slats don't fit, you'll have to shorten them. Drill 4 holes in the slats. Mount them with the 50mm screws. Repeat this procedure on both sides and place them between the sidepanels.

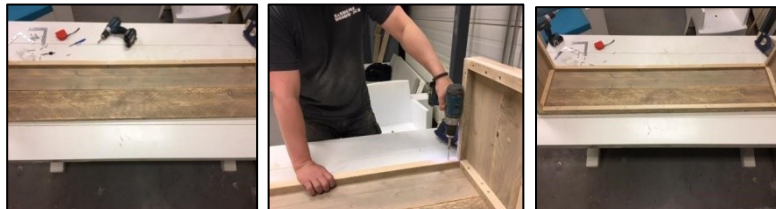

Step 6:

You'll need the following planks and slats:

-1 x 29 x 3 cm slat

Drill 2 holes and mount this in the centre of the 2 planks. use the 50mm to mount them.

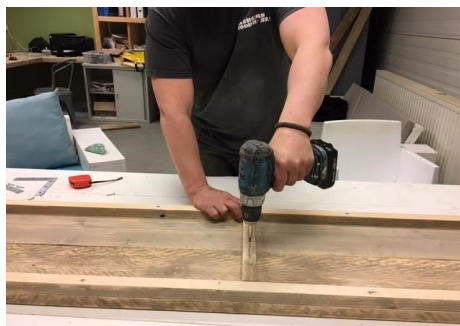

Step 7:

You'll need the 2 shackles

Take the two shackles and mount these between the two slats. Use the 30mm screws. This is to adjust the side panels. After you adjusted the side panels you can flip the bench and it is ready to use.



For a instruction video's , check the link below, it is in Dutch but we will show you step by step how to assemble the bench.

<https://wood4you.eu/info/instructie-filmpjes>

Enjoy!